

ELETTROPOMPE AUTOADESCANTI A MEMBRANA

JDREX - SERIE MARINA/STANDARD

ELECTRIC-SELF PRIMING DIAPHRAGM PUMPS

ELECTROPOMPES AUTO-AMORCANTES A MEMBRANE

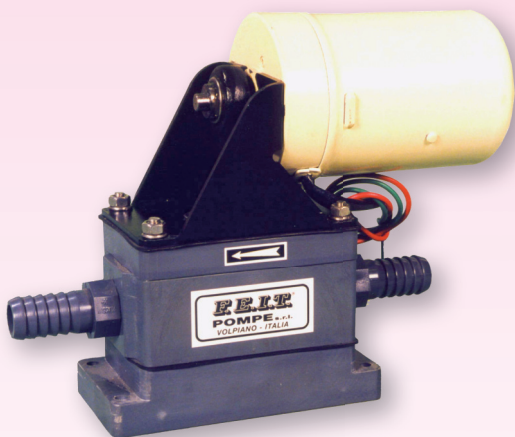

JDREX S15

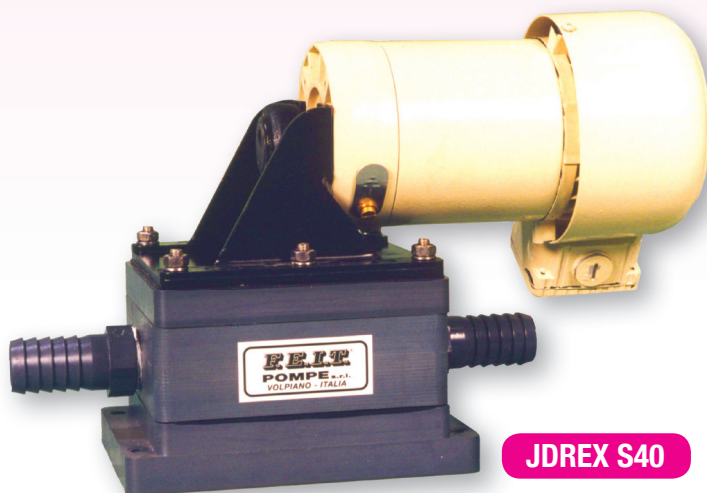

JDREX S40

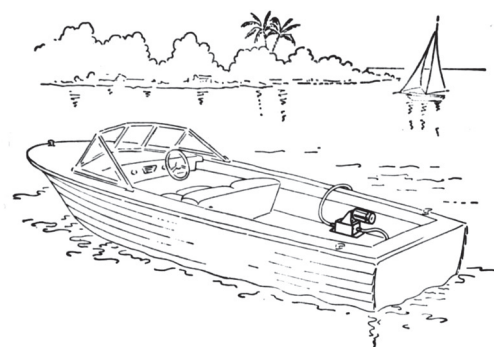
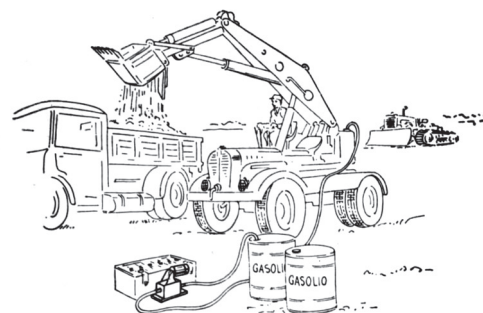
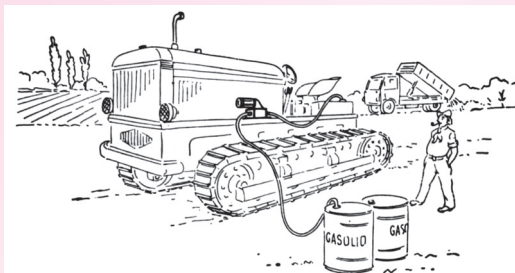

LE POMPE "JDREX" SONO
PARTICOLARMENTE INDICATE PER:

- PROSCIUGAMENTO DI SENTINE E POZZETTI
- RIFORNIMENTO DIESEL
- DISTRIBUZIONE DI ACQUA SU IMBARCAZIONI E CAMPER
- TRAVASI DI ACQUE DOLCI E SALATE
- PRELIEVI ECOLOGICI.



THIS PUMP IS PARTICULARLY
INDICATED FOR:

- EXTRACTING SEA WATER, BILGE.
- TRANSFERRING DIESEL
- WATER SUPPLY FOR TRAILERS, BOATS, CAMPER
- TRANSFERRING SOFT WATER AND SEA WATER
- SAMPLING ECOLOGY



LES POMPES "JDREX" SONT
PARTICULIEREMENT INDIQUEES POUR:

- L'ASSÈCHEMENT DE FOSSES ET DE PUISARDS
- L'ASPIRATION DE CARBURANTS POUR PLEINS
- LA DISTRIBUTION D'EAU SUR BATEAUX ET MOTOR-HOME
- LES TRANSFERTS D'EAU DOUCE ET SALE
- LES PRÉLÈVEMENTS ÉCOLOGIQUES

DIMENSIONI E PESI - DIMENSIONS AND WEIGHTS - DIMENSIONS ET POIDS

Tipo Type	Volt	Amp. Max	Kw	Caratteristiche //performance lt.=litri/min m=metri	Raccordi Ports Raccords
S15	12 o 24	7 4	0,12	m 0 - 2 - 4 - 6 - 8 - 10 lt. 18 - 16 - 15 - 14 - 13 - 12	1/2" gas f 20 mm
S40	12 o 24	12 6	0,20	m 0 - 2 - 4 - 6 - 8 - 10 lt. 37 - 34 - 31 - 28 - 27 - 27	3/4" gas f 25 mm
S40	220 220/380	0,73 0,59/0,34	0,09	m 0 - 2 - 4 - 6 - 8 - 10 lt. 37 - 34 - 31 - 28 - 27 - 27	3/4" gas f 25 mm

- Autoinnesco immediato senza preventivo riempimento del corpo pompa.
- Massima sicurezza di funzionamento anche dopo vari mesi d'inattività.
- Non necessita valvola di fondo, né succheruola, nè filtro.
- Manutenzione nulla.
- Tutti i componenti sono resistenti alla corrosione.
- Possono funzionare a secco in quanto non hanno rasamenti, guarnizioni, giranti, premistoppa, o anelli di tenuta che si danneggiano.

- Immediate self priming without pre filling the body of the pump.
- Maximum reliability of operation, even after being inactive for lengthy periods.
- No foot valves, no filter.
- No maintenance required.
- Quick instillation.
- All components of the pump are resistant to sea water corrosion
- Can run dry without any damage because they have no impeller seals or other delicate or fragile parts.

- Autoamorçage immédiat sans remplissage préalable du corps de la pompe
- Sécurité maximale de fonctionnement même après plusieurs mois d'inactivité
- Pas besoin de soupape de fond, No crépine, no filtre
- Tous les composants résistent à la corrosion
- Peuvent fonctionner à sec étant donné qu'elles n'ont pas de segments racleurs, joints, roues, presse garniture, ou bagues d'étanchéité qui s'abîment

QUOTE DI INGOMBRO / DIMENSIONS

DIMENSIONI E PESI

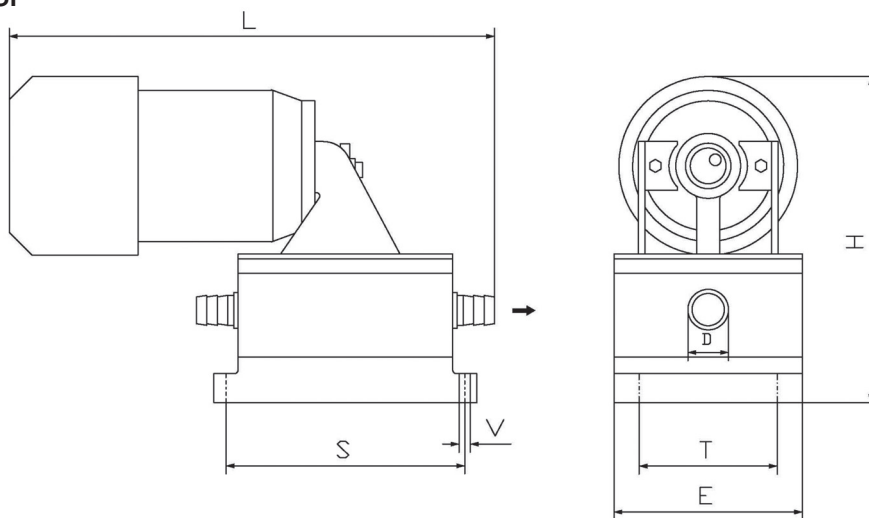

TIPO / TYPE	L	H	E	S	T	V	D	peso (Kg)
JDREX S15	232	163	75	120	52	7	1/2"gas 20 mm	2,8
JDREX S40	290	201	116	144	85	7	3/4" gas 25 mm	4,2
JDREX S40 220-380	290	240	116	144	85	7	3/4" gas 25 mm	4