

# POMPE CENTRIFUGHE - Serie TLC

PER IL PROSCIUGAMENTO SENTINE, IMPIANTI ANTINCENDIO, TRAVASO CARBURANTI ECC.



CENTRIFUGAL PUMPS FOR RELIABLY DRAINING BILGES, FIRE PREVENTION, FUEL PUMPING, ETC.

POMPES CENTRIFUGES POUR L'ASSECHEMENT DE PUISARDS, PROTECTION CONTRE LES INCENDIES, POUR L'ASPIRATION DE CARBURANTS, ETC

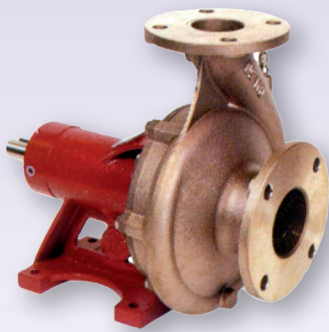

CM 40

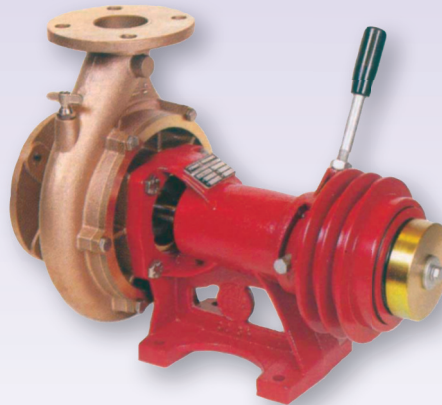

CM 40FD

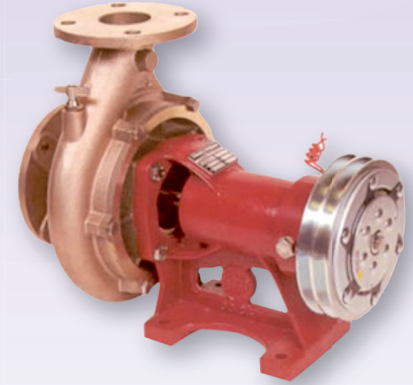

CM 40FE

Tipo Type	Giri Rpm	H (m)	Q (mc/h)										
			3	5	10	15	20	25	30	35	40	45	50
CM 40	2900		30	29	27	24	20	14	6				
	2400		20	19	18	15	10	3					
	2000		15	14	12	7	3						
	1390		8	7	5	4							
CM 50	2900			38	37	36	35	33	32	28	24	20	12
	2400			26	25	24	23	22	19	16	11	7	
	2000			19	18	17	16	13	10	7	4		
	1390			9	8	7	6	4	3				

### CARATTERISTICHE



CORPO: BRONZO  
 GIRANTE: BRONZO  
 DIFFUSORE: BRONZO  
 ALBERO: ACCIAIO INOX AISI 316  
 TENUTA: MECCANICA  
 SUPPORTO: GHISA

#### A RICHIESTA :

- ESECUZIONE AD ALBERO NUDO
- ACCOPPIAMENTO A FRIZIONE MANUALE
- ACCOPPIAMENTO A FRIZIONE ELETTRICA
- ROTAZIONE ORARIA O ANTIORARIA.

### CHARACTERISTICS



BODY: BRONZE  
 IMPELLER: BRONZE  
 DIFFUSER: BRONZE  
 SHAFT: STAINLESS STEEL AISI 316  
 MECHANICAL SEAL  
 SUPPORT: CAST-IRON

#### ON REQUEST:

- EXECUTION WITH BARE SHAFT
- WITH HAND CLUTCH
- WITH ELECTRIC CLUTCH
- ROTATION CLOCKWISE OR ANTICLOCKWISE

### CHARACTERISTIQUES



CORPS: BRONZE  
 TURBINE: BRONZE  
 DIFFUSEUR: BRONZE  
 SHAFT: STAINLESS STEEL AISI 316  
 MECHANICAL SEAL  
 SUPPORT: FONTE

#### SUR DEMANDE:

- EXÉCUTION À L'ARBRE NU
- ACCOUPLEMENT À LA FRICTION MANUELLE
- ACCOUPLEMENT À LA FRICTION ÉLECTRIQUE
- ROTATION HORAIRE OU INVERSE

# DIMENSIONI E PESI - DIMENSIONS AND WEIGHTS - DIMENSIONS ET POIDS

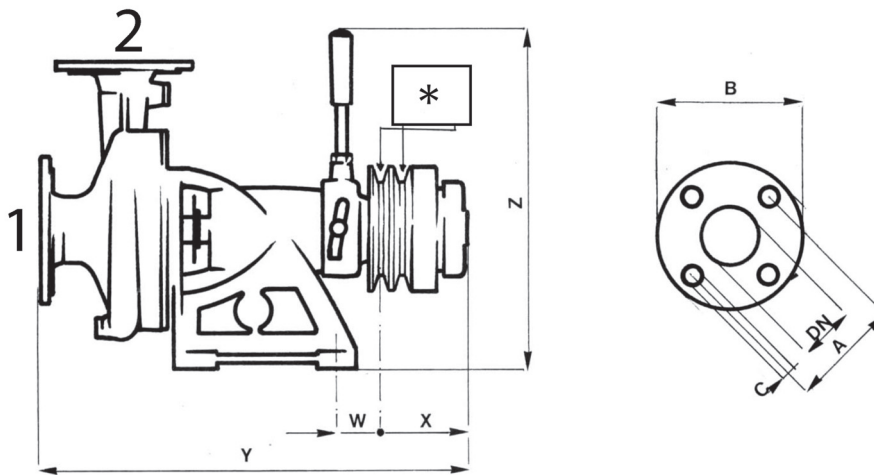
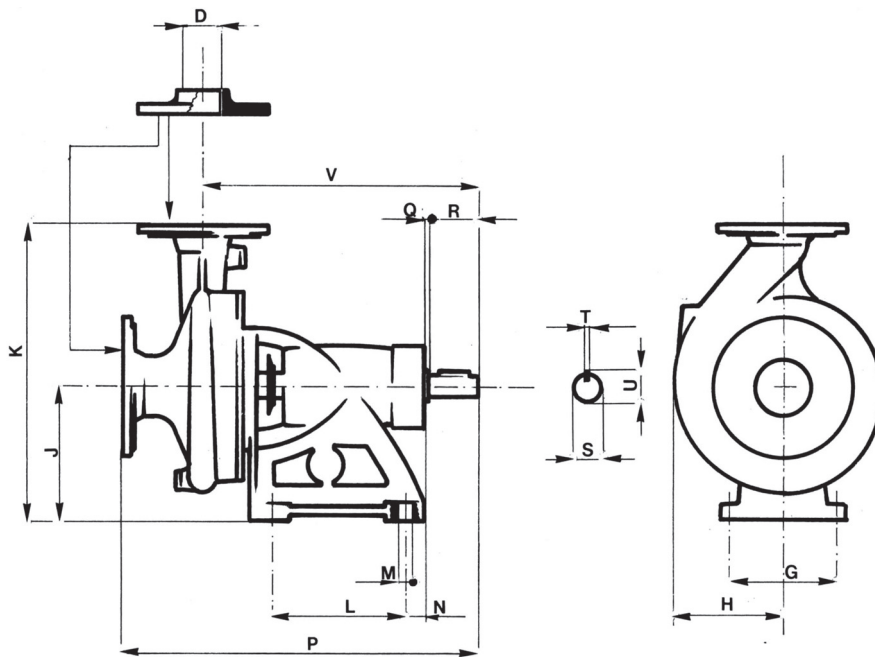

TIPO TYPE	G	H	J	K	L	M	N	P	Q	R	S	T	U	V	W	X	Y	Z	Kg
CM40	100	106	132	292	135	13	20	355	3,5	50	22	6	24,5	276	-	-	-	-	19
CM40F	100	106	132	292	135	13	-	-	-	-	-	-	-	-	43	73	410	345	24
CM50	100	122	132	312	135	13	20	365	3,5	50	22	6	24,5	276	-	-	-	-	21
CM50F	100	122	132	312	135	13	-	-	-	-	-	-	-	-	54	83	418	345	26

TIPO TYPE	DN		A		B		D		C
	1	2	1	2	1	2	1	2	
CM40	50	40	110	100	140	130	2"	1"1/2	14
CM40F	50	40	110	100	140	130	2"	1"1/2	14
CM50	65	50	130	110	160	140	2"1/2	2"	14
CM50F	65	50	130	110	160	140	2"1/2	2"	14

\*diametro pulegge: 110,140 mm  
 \*diameter pulley: 110,140 mm  
 \*diamètre poulie: 110,140 mm